

ITEM #	PART NUMBER	CONFIGURATION	REV	DESCRIPTION	MATERIAL	QTY
1	PT-2057-01	X	A	Heavy Duty Equipment Shelf	8GA ALUMINUM(0.1285)	1

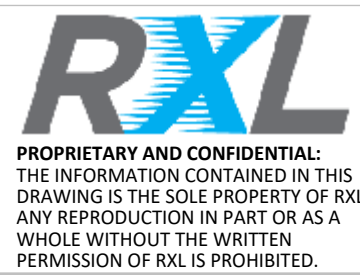
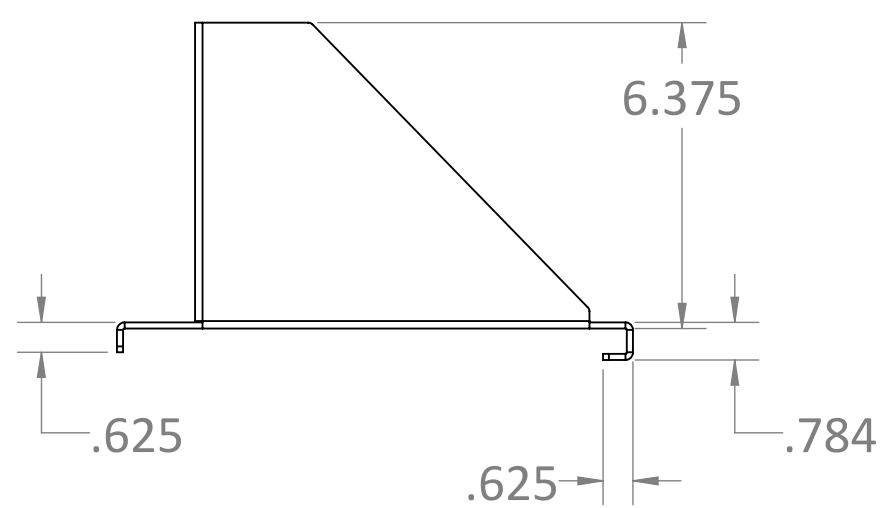
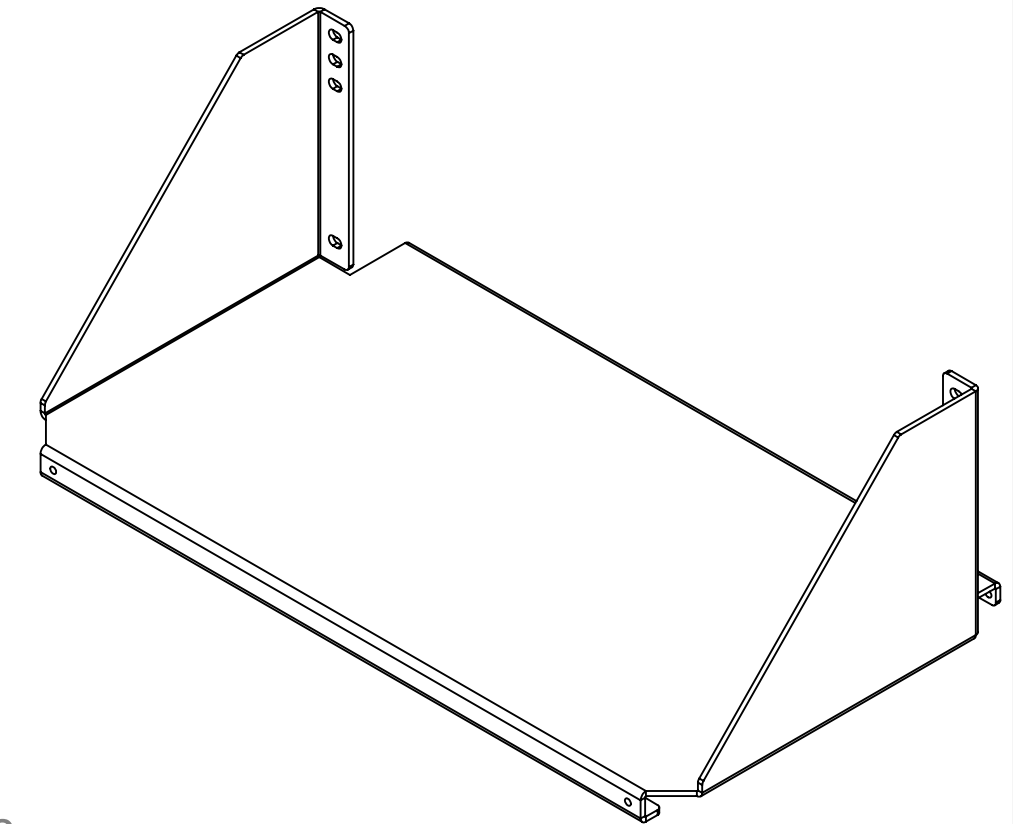
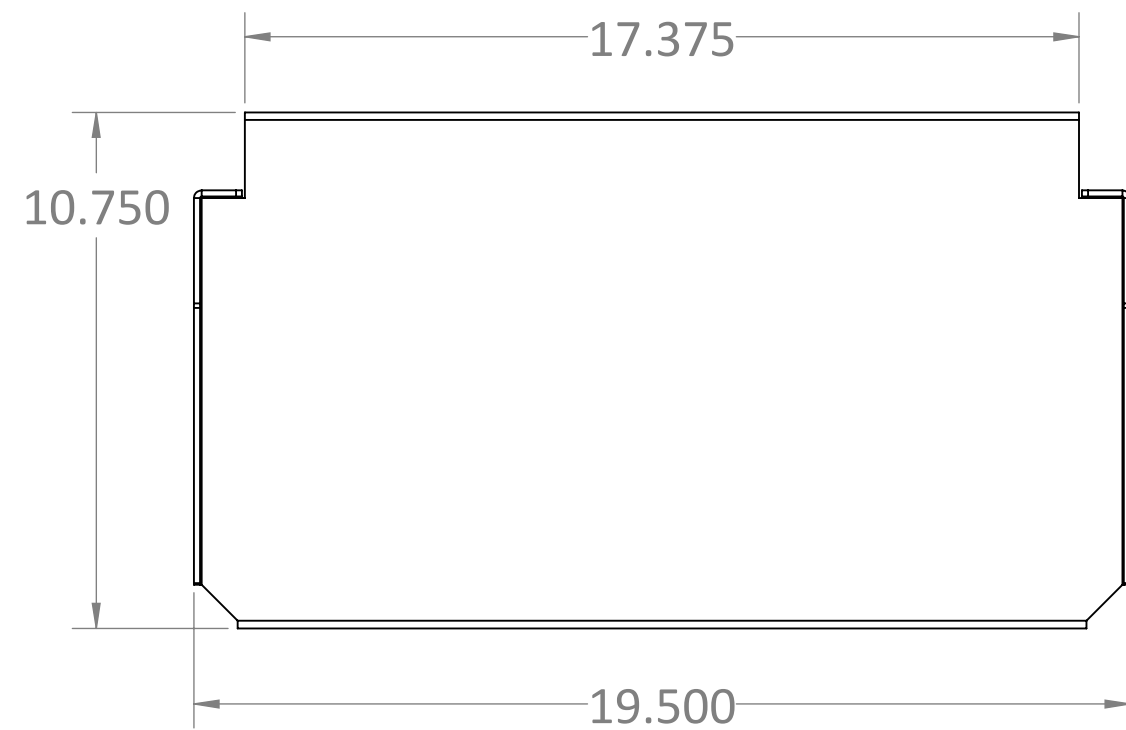

SERIES/FAMILY NUMBER: <b>RXL-2057</b>		CONFIGURATION (SEE TABLE DETAILS/"X" DENOTES COLOR): <b>X</b>
DESCRIPTION: <b>Heavy Duty Equipment Shelf</b>		
REVISION <b>A</b>	DATE <b>10/23/2020</b>	REVISION DESCRIPTION: <b>Initial</b>

COMMENTS/FOLDER PATH:  
B:\RXL Inc\RXL Engineering - General\RXL\Section 2 - Open Racks\RXL-2057 Heavy Duty Equipment Shelf\

UNLESS OTHERWISE SPECIFIED: DIMENSIONS ARE IN INCHES TOLERANCES: ±0.03 FRACTIONAL: ±1/32 ANGULAR: ±1° TWO PLACE DECIMAL ±0.03 THREE PLACE DECIMAL ±0.030		MATERIAL: <b>8GA ALUMINUM(0.1285)</b>	FULL PART NUMBER: <b>RXL-2057-X</b>
		FINISH: <b>NONE</b>	DRAWN BY: Jackson Chong
		WEIGHT: <b>11.17lbs.</b>	DRAWN DATE: 10/23/2020
		SURFACE AREA: <b>629.16in.<sup>2</sup></b>	DO NOT SCALE DRAWING Scale: 1:4
			DRAWING SIZE: <b>B</b> SHEET 1 OF 1